

# Electronic thermostat, multi range, control and manual reset action, for incorporation, Type: 2PE2N6

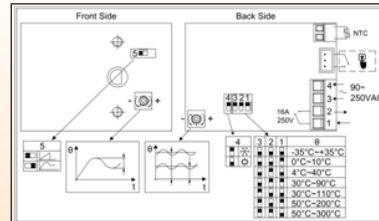
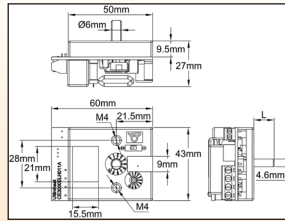
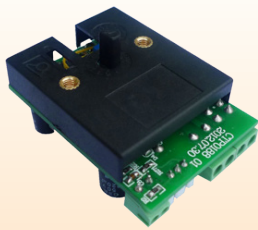

## Main features

This electronic thermostat for incorporation has been designed to replace electromechanical thermostats. It is mounted with two screws M4 at the same distance 28 mm, uses a 6 mm dia. shaft with 4.6 mm flat with the same length, and its rotation angle is 270°. The temperature ranges are the same as the bulb and capillary thermostats, which he can use the graduated knobs. Its electrical rating (16A) is identical. It additionally features adjustable temperature differential, and heating or cooling relay output setting, and control or manual reset action can be set.

**Action:** On-Off

**Temperature sensors:**

- NTC thermistor, 10Kohms @25°C, B(25-50)= 3380, for temperatures ranges from -30°F (-35°C) to 250°F (120°C).  
 - NTC thermistor, 500K@25°C, B(25-50)= 4260, for temperature ranges 120-390°F (50-200°C) and 120-570°F (50-300°C).

**Accuracy:** +/-1% of scale (NTC sensor tolerances not included)

**Size:** 60 x 43 x 23 mm

**Temperature adjustment ranges:**

Temperature range selection is made by dip switch on the printed circuit. 270° angulation set span

**Control or manual reset selection:** can be selected with a miniature dipswitch on the circuit

**Power supply:** 90 to 240V, 50Hz or 60Hz

**Relay output:** SPNO, 16A250V res., 100000 cycles.

**Relay action:** Heating or cooling, open or close on temperature rise output relay action can be selected by a dip switch with access from front side

**Ambiant:** -20+50°C, 10-85% RH

**Power:** <2W

**Electrical connections:**

- Power supply and power relay: 2.5 mm<sup>2</sup> screw terminal

- Temperature sensor: 1.5 mm<sup>2</sup> screw terminal

- Manual reset: with miniature JST connector

**Adjustment shaft:** the thermostat is shipped with a dia. 6mm with 4.6 mm flat shaft, length 11 mm, assembled.

**Included spare parts:** a 28 mm shaft and a screw driver adjustment shaft.

**Standards:** Comply with EMC (CE), ROHS and Reach

## Parameters adjustment

**Temperature differential:** Adjustable, by potentiometer with front access

Temperature adjustment ranges °C (°F)	Differential adjustment °C (°F)
-35+35°C (-30+95°F)	0.5~5.5°C (0.9~10°F)
0-10°C (32-50°F)	0.5~2.5°C (0.9~4.5°F)
4-40°C (40-105°F)	0.5~2.5°C (0.9~4.5°F)
30-90°C (85-190°F)	0.5~5.5°C (0.9~10°F)
30-110°C (85-230°F)	0.5~5.5°C (0.9~10°F)
50-200°C (120-390°F)	0.5~5.5°C (0.9~10°F)
50-300 °C (120-570°F)	1~10°C (1.8~18°F)

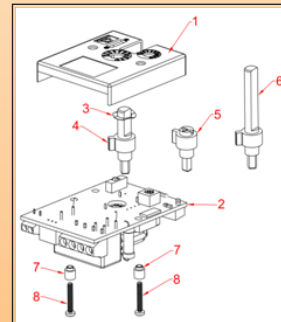

- 1: Cover
- 2: Printed circuit
- 3: Elastic washer
- 4: 11 mm shaft fitted in standard
- 5: Screw driver shaft
- 6: 28 mm shaft
- 7: Plastic washer
- 8: Cover screws, (to unscrew to change shaft type)

Reference	2PE2N6
-----------	--------

Accessories (Must be ordered separately, not included in the electronic thermostat)

## Manual reset switch

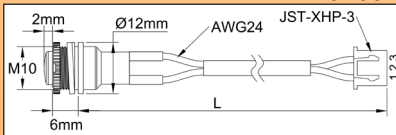

Wired switch for manual reset. Needs a 10 mm dia. hole in the mounting board.

Reference	2PMR100 (L=100 mm) Other length on request
-----------	--

## 66MZ Soft grip printed knob references

°C Printing

-35+35°C	0-10°C	4-40°C	30-90°C	30-110°C	50-200°C	50-300°C
66MZ006-350352FW	66MZ0060000102FW	66MZ0060040402FW	66MZ0060300901FW	66MZ006031101FW	66MZ0060502001FW	66MZ0060503001FW

°F Printing

66MZ006-350352FX	66MZ0060000102FX	66MZ0060040402FX	66MZ0060300901FX	66MZ006031101FX	66MZ0060502001FX	66MZ0060503001FX

## Knobs and bezels

Dimensions	References	Material
	66MZ.....	PC+Santoprene
	66EN1	Black ABS
	66EN3	Chrome plated ABS
	66EN2	Stainless steel

Many other knobs are available, see last section of this catalogue

## Standard temperature sensor (For more models see catalogue N°3)

All ranges from -35°C to +110°C (-30+230°F)  
 10Kohms @25°C, B= 3380

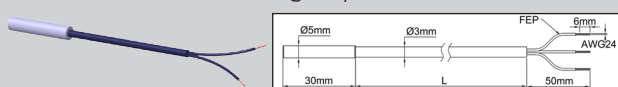

**Accuracy:** +/-2,5% on R25 e+/-2% on B  
**Temperature range:** -20°C+120°C  
**Probe:** Nickel plated copper, 6x30 mm  
**Cable:** FEP, T200°C, length 2m  
**Polarity:** non polarized

Reference	TNR60030C20001F
-----------	-----------------

Ranges 50°C-200°C(120-390°F) and 50°C-300°C (120-570°F)  
 500K@25°C, B(25-50)= 4260

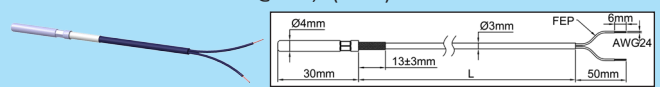

**Accuracy:** +/-2,5% on R25 e+/-2% on B  
**Temperature range:** ambient to 300°C (570°F)  
**Probe:** stainless steel, 4x30 mm  
**Cable:** FEP, T200°C, length 2m  
**Polarity:** non polarized

Reference	TMR40030C20001F
-----------	-----------------

Because of permanent improvement of our products, drawings, descriptions, features used on these data sheets are for guidance only and can be modified without prior advice

Unless exceptionally specified by this logo, products and components in this catalogue are made by Ultimheat alliance members.

