

## Safety devices

Most of the heating elements have a power optimized according to the specific parameters of environment (Gas, liquid) to be heated, and especially to its specific heat exchange coefficient and the speed of fluid circulation. When the heat exchange conditions change: for instance, water flow stop while heating liquids, airflow stop in the air heaters, flat heating elements separated of their exchangers, overheating occurs that might lead to fire hazards, property damages or risk to humans being. These security systems have many designs. This is why the complementary housings have been designed to receive capillary security systems with sealed capillary bushings, pockets for thermostat bulbs, temperature sensors or thermal fuses, disc thermostats with manual or automatic reset.

The pockets and bushings are equipped with the same gasket system and use the same tapped holes.

### Standard options for security devices mounting



2 available slots for disc thermostats. They have extended cup brackets, for throw wall mounting to limit the thermal inertia in air heating systems devices. Safety or control applications. Disc thermostats: see page 130



1 available slot for extended cup bracket disc thermostat with manual reset. Allows manual reset from the outside of the box. Side push button kit: see page 129  
Thermostat: see page 130



1 available slot for a bulb and capillary cut-out. Allows manual reset from the outside of the box. The thermostat bulb can be in a pocket or external, with a stuffing box. See page 129



1/4" BSPP holes with gasket seat for pocket and capillary stuffing boxes. See page 129

### Standard outlet options for safety devices



1/4" BSPP thread with cap. See page 129

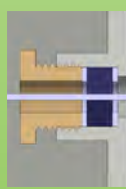

1/4" BSPP thread with capillary stuffing box. See page 129

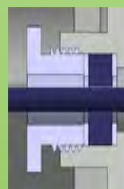

1/4" BSPP thread with stuffing box for sensor cable. See page 129

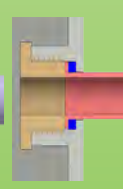

1/4" BSPP thread with pocket outlet, for dia. 6mm sensor. See page 129



1/4" BSPP thread with pocket outlet for dia. 8mm thermal fuse or temperature sensor. See page 129 and 130

Because of permanent improvement of our products, drawings, descriptions, features used on these data sheets are for guidance only and can be modified without prior advice

